

# Unit Plan

## FLAT C | 2B 2T

Tower G & H

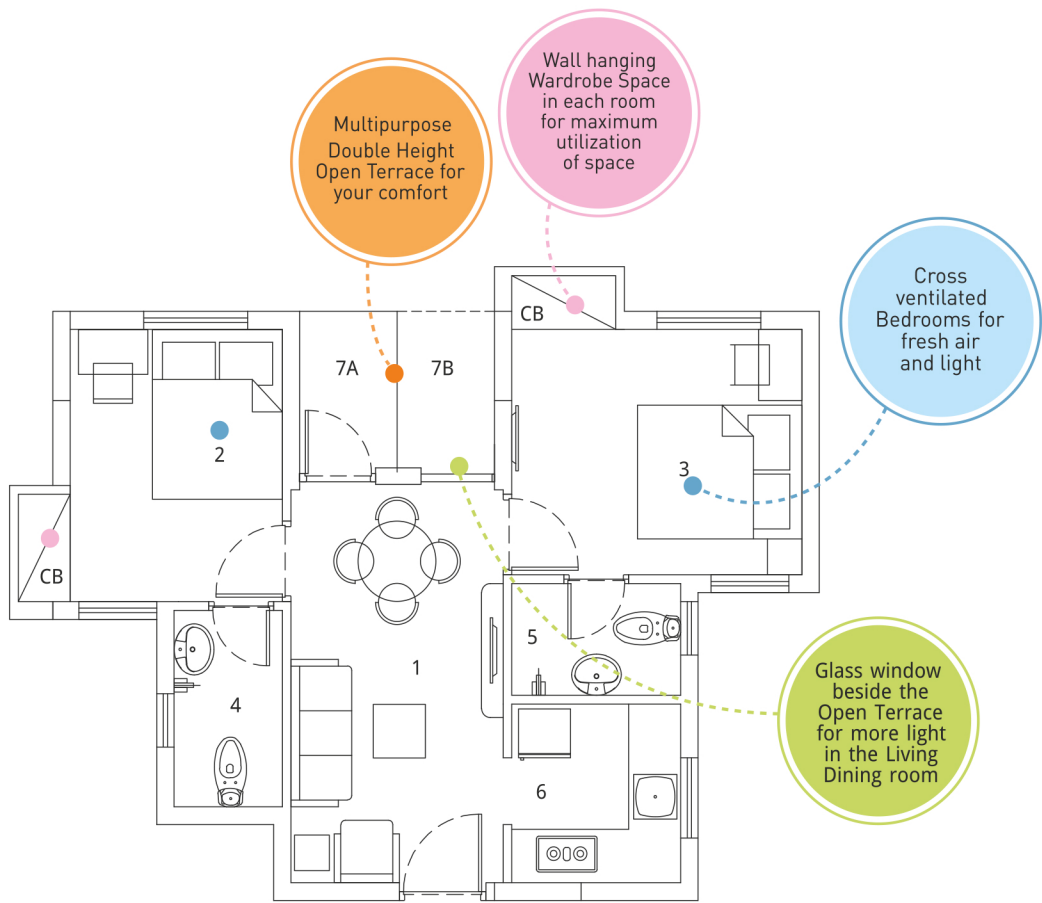

Carpet area 423 sq ft  
Built up area 508 sq ft  
Standard built up area 710 sq ft

1	Living/Dining	8'0"x14'5"
2	Bedroom	10'0"x10'0" (8'0"x10'0" without CB)
3	Bedroom	11'0"x11'0" (11'0"x9'0" without CB)
4	Toilet	7'3"x4'1"
5	Toilet	6'5"x4'1"
6	Kitchen	6'5"x6'7"
7A*	Open terrace	3'8"x5'11"
7B*	Open terrace	3'8"x5'11"